

REASSEMBLY

1. INSTALL STARTER ARMATURE ASSEMBLY

- (a) Apply grease to the bearings, and install them onto the stater yoke.

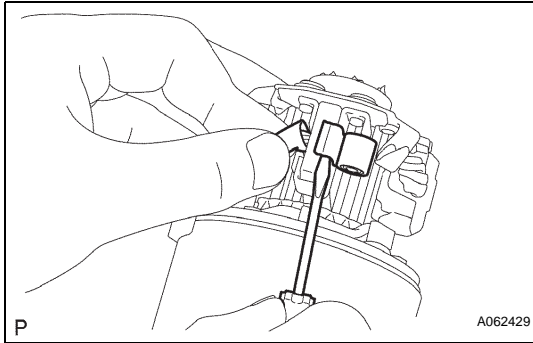

2. INSTALL STATER BRUSH HOLDER ASSEMBLY

- (a) Install the a new O-ring onto the groove of the starter yoke assembly.
- (b) Place the brush holder on the armature.
- (c) Using a screwdriver, install 4 brushes.

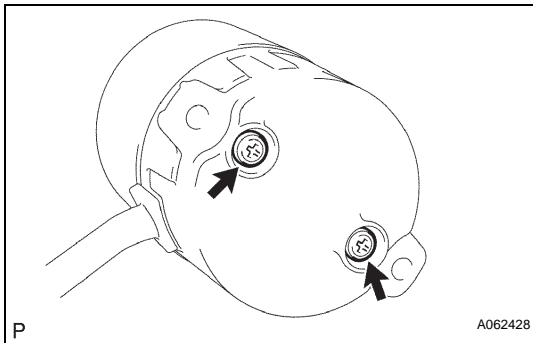

- (d) Install the commutator end frame with the 2 screws.
Torque: 3.8 N*m (39 kgf*cm, 34 in.*lbf)

3. INSTALL MAGNET STARTER SWITCH ASSEMBLY

- (a) Apply grease to the steel ball, and install it onto the clutch shaft hole.

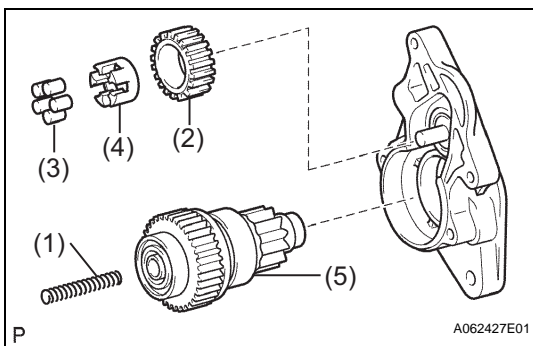

- (b) Apply grease to parts (2) to (5), and install all the parts below onto the starter drive housing.

(1)	Starter magnet switch return spring
(2)	Starter idle gear pinion
(3)	Starter idle gear clutch roller
(4)	Starter idle gear retainer
(5)	Starter clutch

- (c) Install the magnet starter switch with the 2 screws.
Torque: 9.3 N*m (95 kgf*cm, 82 in.*lbf)

4. INSTALL STARTER YOKE ASSEMBLY

- (a) Install a new O-ring onto the groove of the starter yoke.

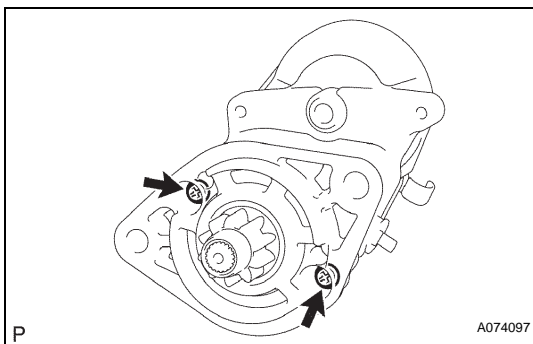

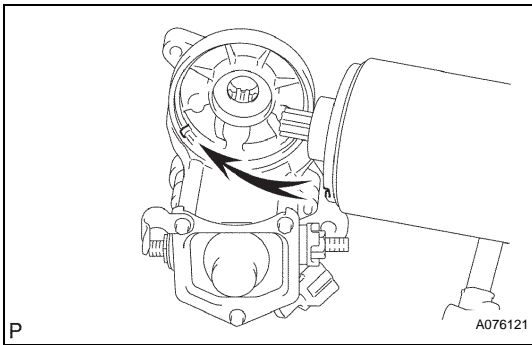

- (b) Align the key of the starter yoke with the groove of the magnet starter switch.

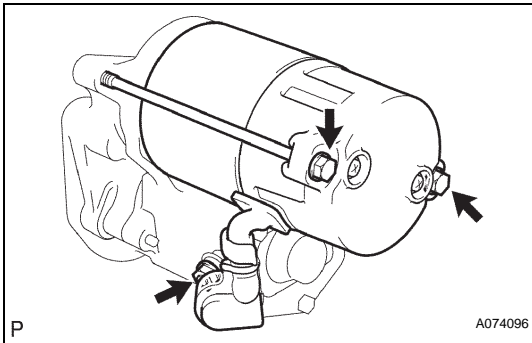

- (c) Install the starter yoke and armature with the 2 through bolts.
Torque: 9.3 N*m (95 kgf*cm, 82 in.*lbf)
 (d) Connect the lead wire to terminal C with the nut.
Torque: 5.9 N*m (60 kgf*cm, 52 in.*lbf)

INSTALLATION

1. INSTALL STARTER ASSEMBLY

- (a) Install the starter assembly with 2 bolts.
Torque: 37 N*m (377 kgf*cm, 27 ft.*lbf)

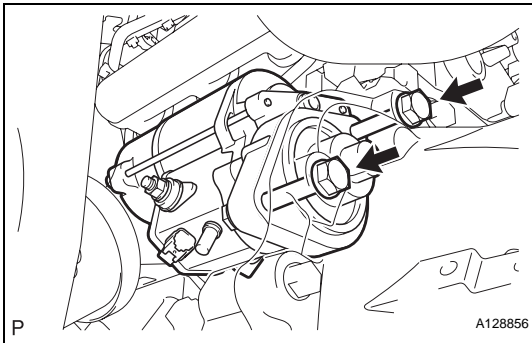

- (b) Connect the wire harness to the terminal 30, then install the nut.
Torque: 5.9 N*m (60 kgf*cm, 52 in.*lbf)
 (c) Connect the terminal 50 connector to the starter assembly.

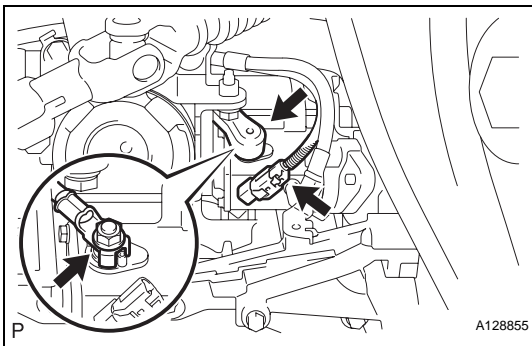

2. INSTALL WIRE HARNESS

- (a) Install the wire harness onto the cylinder block with the bolt.
Torque: 13 N*m (133 kgf*cm, 10 ft.*lbf)

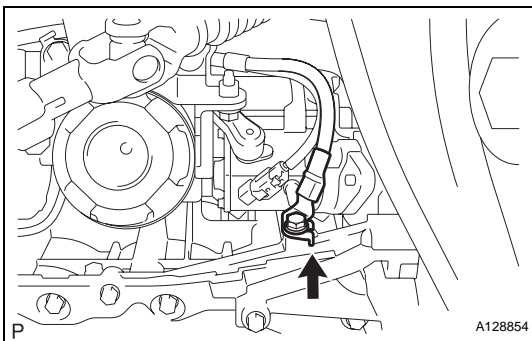

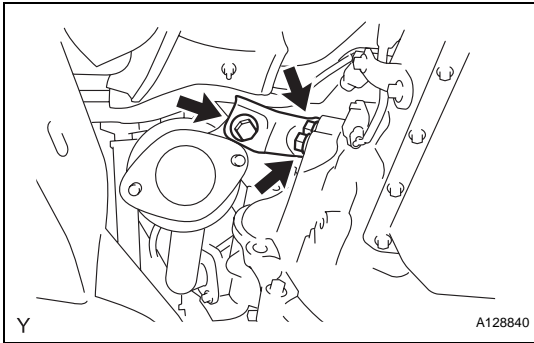

3. **INSTALL NO.2 EXHAUST MANIFOLD STAY**
 - (a) Install the No. 2 manifold stay with the 3 bolts.
Torque: 40 N*m (408 kgf*cm, 30 in.*lbf)
4. **INSTALL NO.2 ENGINE UNDER COVER ASSEMBLY**
 - (a) Install the No. 2 engine under cover with the 4 bolts.
Torque: 29 N*m (296 kgf*cm, 21 ft.*lbf)
5. **CONNECT CABLE TO NEGATIVE BATTERY TERMINAL**
Torque: 3.9 N*m (40 kgf*cm, 35 in.*lbf)